

CRIB ROOM & OFFICE LAYOUT 1:50

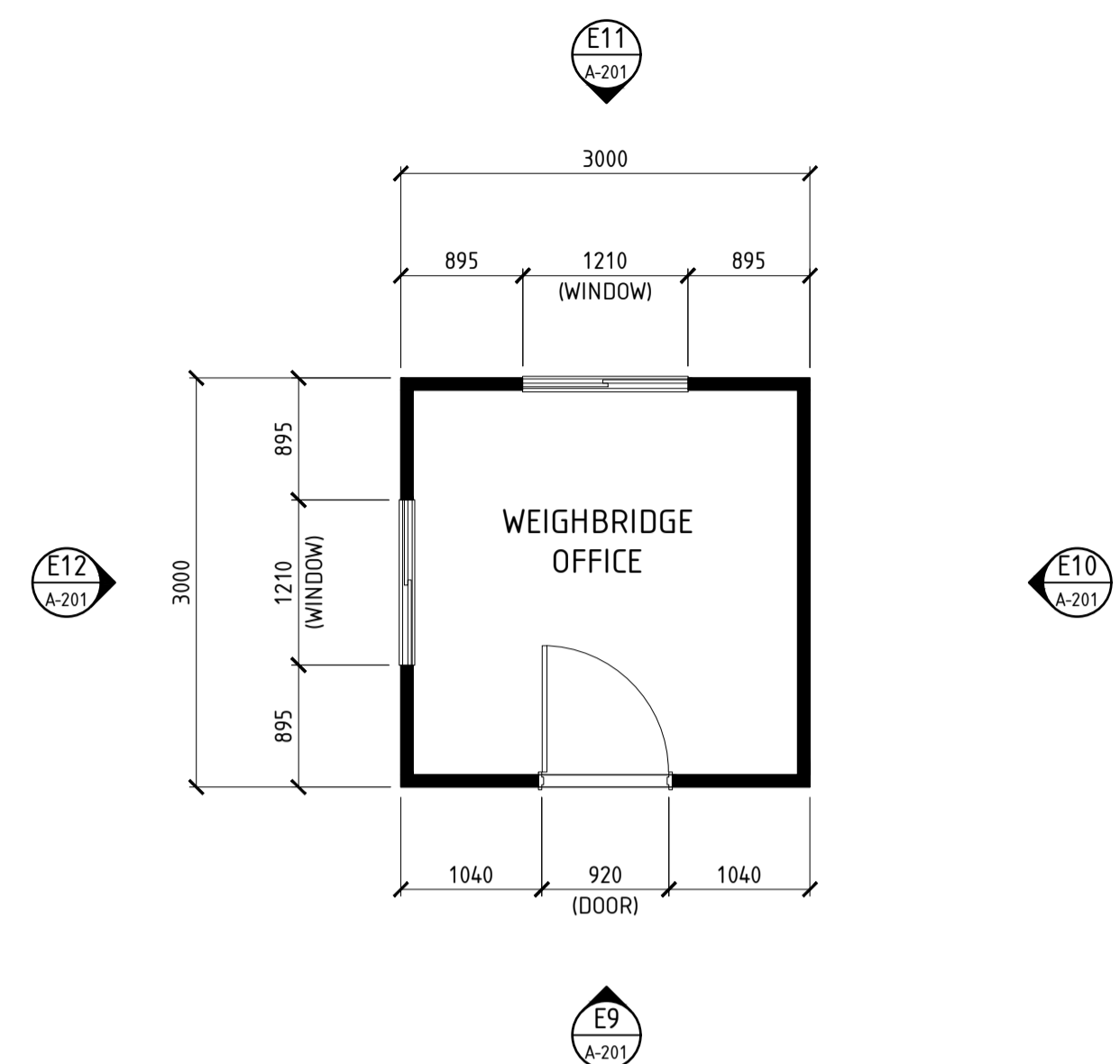

WEIGHBRIDGE OFFICE LAYOUT 1:50

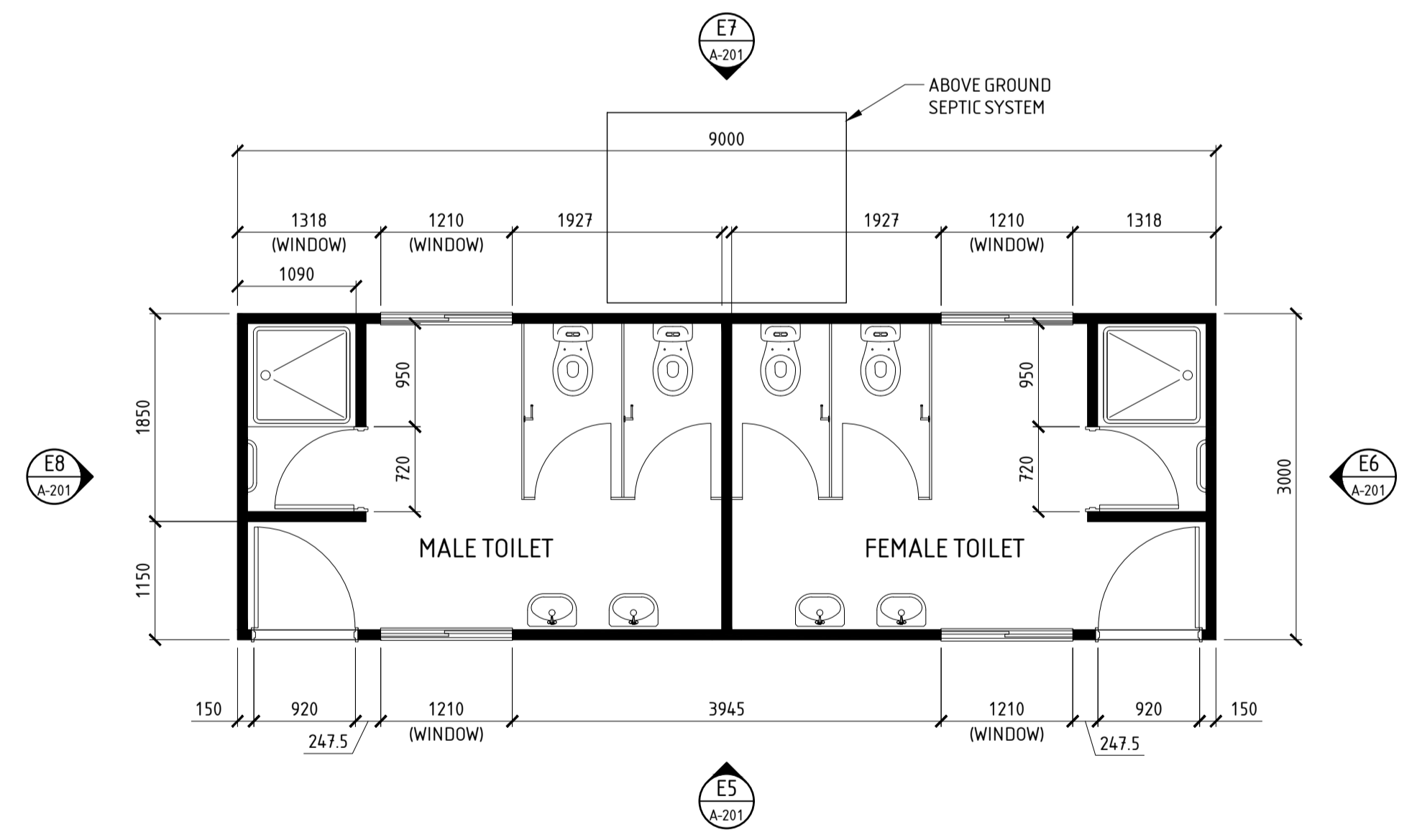

TOILET BLOCK LAYOUT 1:50

| REV | BY | DATE | ISSUE / REVISION DESCRIPTION | CHK | APP |
|-----|-----|----------|------------------------------|-----|-----|
| C | DES | 14.07.17 | ISSUED FOR APPROVAL | PC | PC |
| B | DES | 13.07.17 | ISSUED FOR REVIEW | PC | PC |
| A | DES | 12.07.17 | ISSUED FOR REVIEW | PC | PC |

| TITLE | NAME | DATE |
|--------------------|----------------|------------|
| DRAFTSPERSON: | DENI SOKOLOVIC | APRIL 2017 |
| DESIGNER: | PAUL COLLEY | APRIL 2017 |
| ENGINEERING CHECK: | ENGINEER | --- |

CLIENT

Zemlia Pty Ltd (ABN: 71 349 772 837) ATF the Young Purich and Higham Unit Trust trading as **StrucTerre Consulting Engineers**
 1 Erindale Road, Balcatta, WA, 6021
 Tel. (08) 9205 4500, EMAIL: commercial@strucTerre.com.au

PROJECT: BLUEVALE RD, GUNNEDAH NSW

TITLE: **ROOM LAYOUTS**

STATUS: **APPROVAL**

SCALE: 1:50

DRAWING REF. No: 1.17.14482-A-101

REV: C