

# NARRABRI CBD UPGRADE

## Stage One Fact Sheet

Issue 2 | June 2017

Works will commence next week (**3 July 2017**) on Stage One of the upgrade of the Narrabri CBD. These works are based on the Narrabri CBD Masterplan and will address the main three priorities of creating more shade with centre median plantings, new CBD centre median lighting and no loss of CBD car parking.

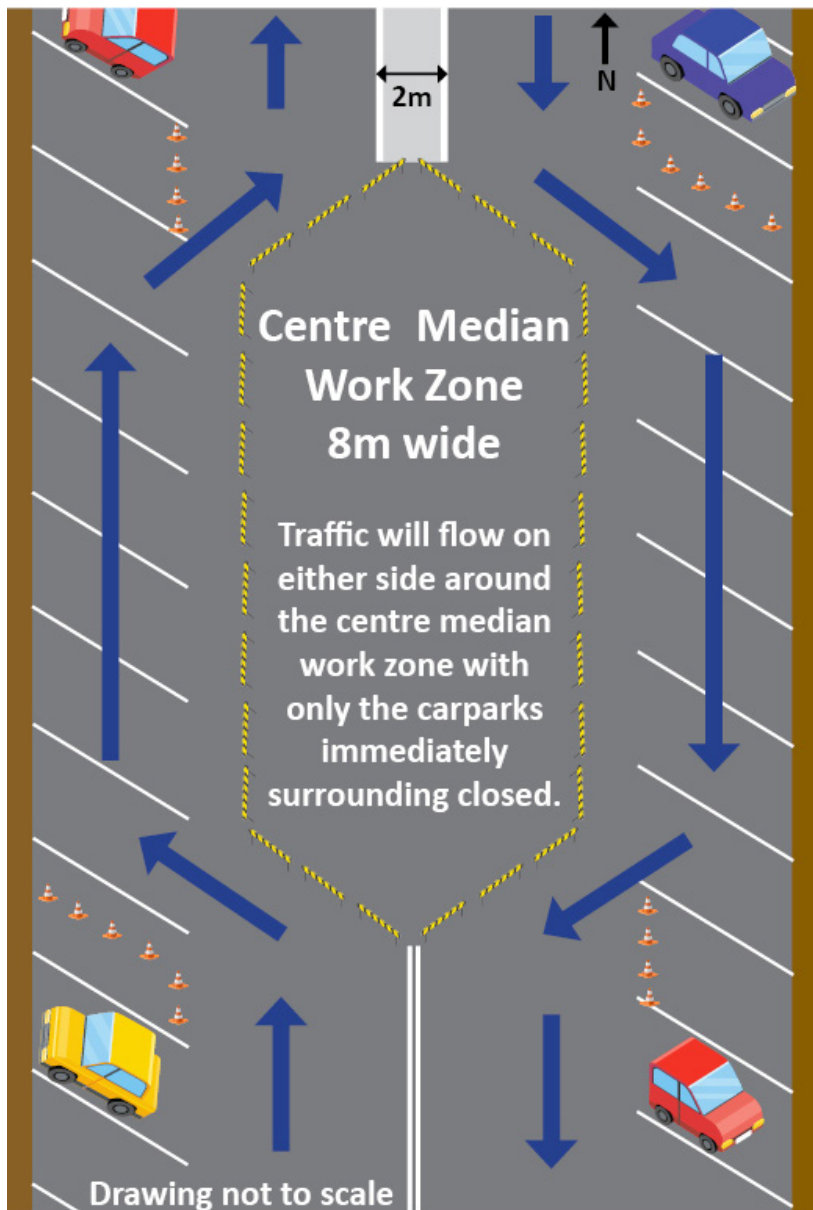

### TRAFFIC MANAGEMENT

Council has been working closely with contractors to develop a Traffic Management Plan that will cause minimal disruption to the CBD parking over the period of works.

Works will take place in an 8 metre wide work zone in the centre of the street. These works will include;

- Excavation of tree holes and installation of gravel, root guard, soil and protection bollards.
- Installation of electrical cabling for centre median lighting.
- Irrigation civil works.
- Installation of the kerb and infill for the 2 metre centre median.

Tree, electrical and irrigation works will be restricted to a shorter work zone (approx 20 metres). Kerb and infill will require a longer work zone (approx 100 metres) to enable continuous pouring of concrete.

It is estimated that each block of the street will take 30 - 40 days to complete with works commencing at the northern end of the Lloyd to Doyle Street Block (Crossroads Hotel end).

Whilst works are carried out, carparks on either side of the work zone will be closed to parking and traffic will flow around the worksite through those car parks (see **diagram**). In most instances, only the parks directly in the work zone will be affected.

Occasionally there may be a need to shut off sections of the street due to heavy machinery or specific works being carried out. These interruptions will be kept to a minimum.

Additional parking is available in Tibbereena Street between the Narrabri Aquatic Centre and the Newell Highway intersection, the TAFE carpark and The Crossing Theatre carpark as well as side streets.

### Stage One - Progress to date

